

ROUNDHAY FESTIVAL

ALL THINGS ORCHESTRAL 2026

ACCESS INFORMATION

TRAVEL TO ACCESSIBLE ENTRANCE:

Accessible Parking (Mansion Lane):
123m (3 mins)

North PUDDO (Park View Crescent):
321m (7 mins)

Public Car Park (Connaught Fields):
1,126m (16 mins)

City Centre Festival Shuttle Bus Stop (Tram Car Park):
643m (8 mins)

Shuttle buses have level access and are able to accommodate one wheelchair user.

TERRAIN: Access to the Accessible Entrance, on Mansion Lane, is via a hard standing path and has hard standing paths linking to the event site. The East and West entrance is via uneven terrain so it is strongly recommended that customers with accessibility requirements use the Accessible Entrance.

To access the arena bowl from the West Entrance, customers must use the Hill 60 steps or make their way down Hill 60 itself. Please note that Hill 60 is steep and is via uneven terrain.

Dedicated accessible buggies are available to assist guests if required on site, customers can contact the nearest steward or welfare for assistance.

LOWERED COUNTERS: There will be lowered counters at the box office and where possible at bars, merchandise stands, and some food outlets.

For any accessible info not shown on this map, please ask at **A**: The Access Customer Service Hub. Our Access Manager will be based here and will also be contactable on radio during the event.

TOILETS: Accessible Toilets are located at The Main Stage Accessible Viewing Area, West and East Welfare Tents, East Stage Ground Level Viewing Area and the American Express VIP Summer Garden. These toilets will not require a radar key but are reserved for customers with Access requirements only. Additional accessible toilets will also be available on site. For the most up to date information on the location of these toilets and how to access them, please visit the Access Customer Service Hub or check the Accessibility section of the website.

KEY

- TOILETS
- ACCESSIBLE TOILETS
- WATER POINT
- BAR
- COCKTAIL BAR
- FOOD TRADERS
- MERCHANDISE
- MEETING POINT
- BIKE PARK
- FIRST AID MEDICAL CENTRE
- BOX OFFICE
- TICKET UPGRADES
- ROAD CLOSURE
- FAIRGROUND
- ACCESS CUSTOMER SERVICE HUB
- BLUE BADGE CAR PARKING
- DOG SPENDING AREA
- HEARING LOOPS will be located at Box Offices, Welfare Tents and Access Customer Service Hub.
- ACCESSIBLE VIEWING AREA
- ACCESSIBLE GROUND LEVEL VIEWING AREA
- WELFARE
Lost Property, Internal Meeting Point, Phone Charging, Quiet Space

ACCESSIBLE WALKING ROUTE

100m APPROXIMATE SCALE BAR

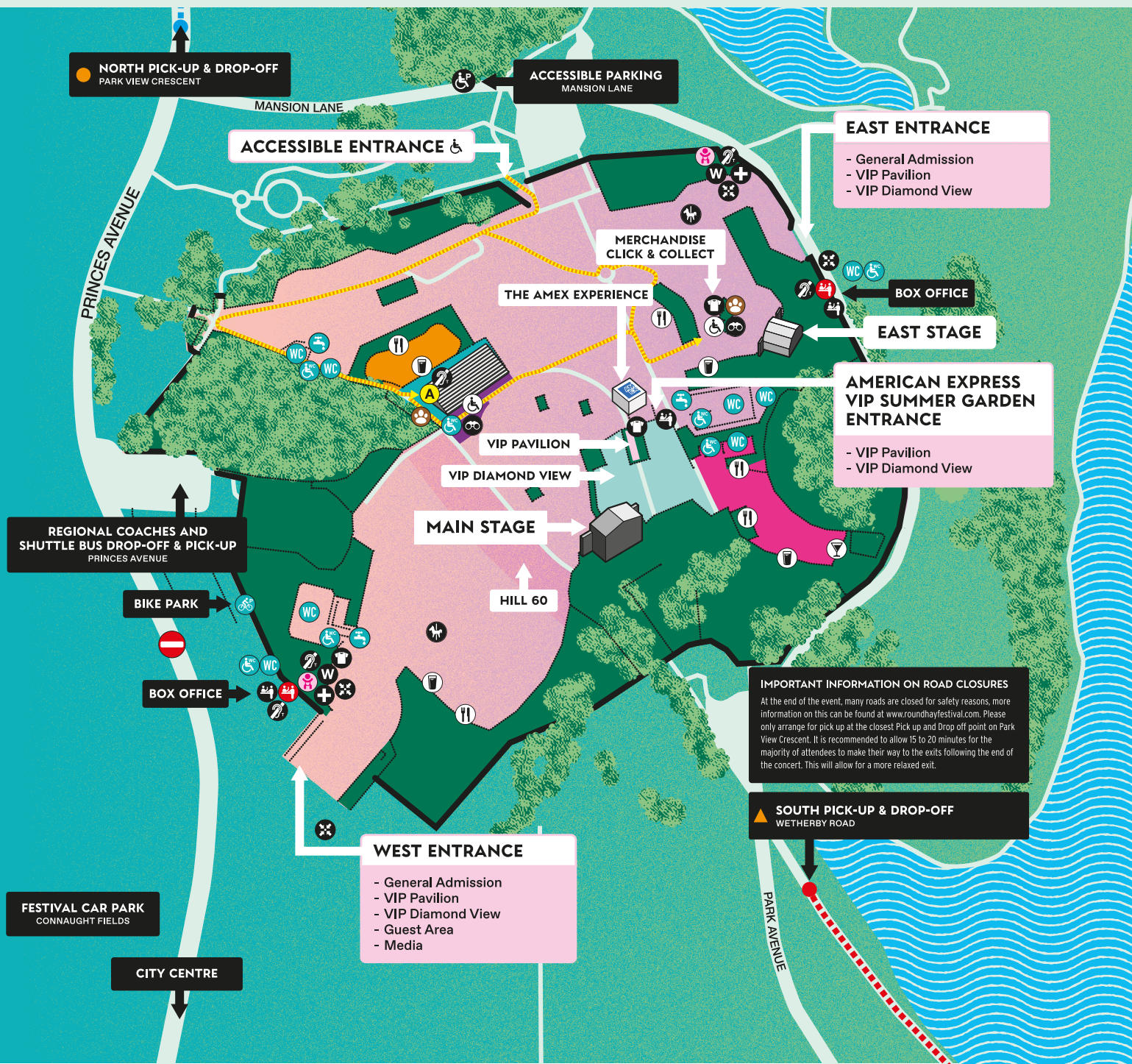

IMPORTANT INFORMATION ON ROAD CLOSURES
At the end of the event, many roads are closed for safety reasons, more information on this can be found at www.roundhayfestival.com. Please only arrange for pick up at the closest Pick up and Drop off point on Park View Crescent. It is recommended to allow 15 to 20 minutes for the majority of attendees to make their way to the exits following the end of the concert. This will allow for a more relaxed exit.